

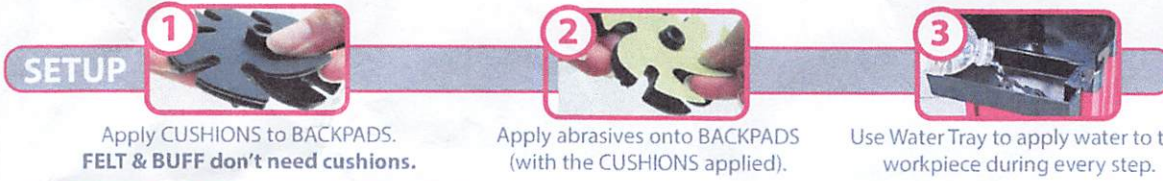

GLASS & ENAMEL POLISHING ADD-ON KIT K-2006



HOW TO SHAPE & POLISH

FOLLOW STEPS FROM TOP TO BOTTOM to take **ROUGH** enamel to a **POLISH**

ANIE'S TIP: For best results, follow ALL steps THOROUGHLY & inspect your piece after each step.



Step 1

STEP 1 VERY FAST GRINDING & SHAPING of your piece

Use **3M Flex-Diamond (X COARSE)** abrasive for VERY AGGRESSIVE material removal.

Speed: High speed with water

1 X COARSE
Item # D-36074-1

STEP 1b (ALTERNATIVE)

Use **3M Microfinishing Diamond (COARSE)** abrasive for more gradual material removal.

Speed: High speed with water

ALT 1b COARSE
Item # D-3074-2



Step 2

STEP 2

REFINE the shape and remove scratches:

Use **3M Microfinishing Diamond** abrasives to finalize the shape and remove any leftover scratches.

2a MEDIUM
Item # D-3045-2

STEP 2b (ALTERNATIVE)

Use for more gradual scratch removal.

ALT 2b FINE
Item # D-3030-2

Speed: Medium speed with water



Step 3

FINAL STEP HIGH-POLISH your piece:

Glass can be polished easily with the **FELT DISC**.

Speed: High Speed. DO NOT USE WATER

2c VERY FINE
Item # D-3020-2

3 FELT DISC
Item # B-301

Use with **COMPOUND** Item #: C-103

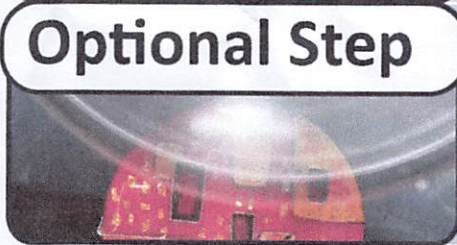

Optional Step

OPTIONAL FINAL STEP: POLISHING

You can also use **3M Cerium Oxide** to get a final polish. Try this after step 2c.

WARNING: Do NOT use on porous surfaces

Speed: Very Slow (with a lot of water)

Pressure: Use gentle but consistent pressure.

OPTIONAL 3 FINAL STEP:
Cerium Oxide
Item # AT-13000-2

TO REMOVE SCRATCHES OR CHIPS from FINISHED stones

Repairing scratched or chipped pieces is similar to working on rough glass.

For DEEP Scratches: Start at Step **2b** then continue up to FINAL STEP **3** or OPTIONAL **3**

For LIGHT scratches, try the polishing steps directly: FINAL STEP **3** or OPTIONAL **3**