

Always use the diamond polishing kit on a clean, dry surface. Do not use on wet or oily surfaces. The diamond polishing kit is not intended for use on jewelry or other delicate items.

DIAMOND POLISHING KIT

Always use the diamond polishing kit on a clean, dry surface. Do not use on wet or oily surfaces. The diamond polishing kit is not intended for use on jewelry or other delicate items.

STEP 1
DO NOT RUB OFF THE DIAMOND
CAN RUB THE ANGLE OF THE DIAMOND
DO NOT RUB OFF THE DIAMOND
DO NOT RUB OFF THE DIAMOND

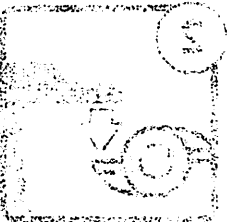

STEP 2
Hold in place
edge of the
diamond

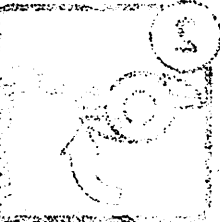

STEP 3
the diamond
edge of the
diamond



FOLLOW FROM
TOP TO BOTTOM

Use the COARSE Microfinishing Diamond
This is a very fine diamond thickness
Use the COARSE Microfinishing Diamond
This is a very fine diamond thickness

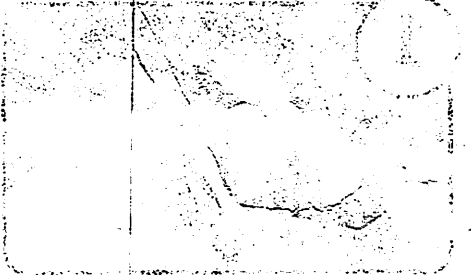

Use the MEDIUM Microfinishing Diamond
This is a medium diamond thickness
Use the MEDIUM Microfinishing Diamond
This is a medium diamond thickness



Use the FINE Microfinishing Diamond
This is a fine diamond thickness
Use the FINE Microfinishing Diamond
This is a fine diamond thickness

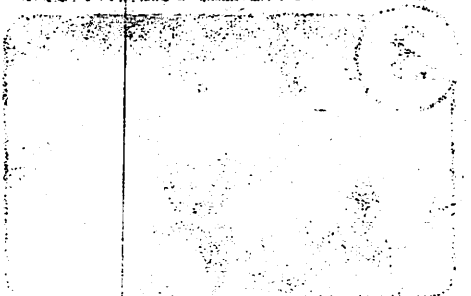

Always use the diamond polishing kit on a clean, dry surface. Do not use on wet or oily surfaces. The diamond polishing kit is not intended for use on jewelry or other delicate items.

CARBIDE SHARPENING KIT

SHARPENING STEPS FOR CARBIDE & EXOTIC ALLOYS

NOTE: Certain kits may have had **SETUP STEPS A & B** already done for you during packaging.

SETUP



Apply CUSHIONS to BACKPADS.
FELT DISC does not need a cushion



Apply abrasives onto BACKPADS
After STEP A.



Screw Backpad onto
the Spindle of the JOOLTOOL



IMPORTANT! Only attempt to sharpen edges that can physically be touched by the abrasives. If the edge is inaccessible, remove the cutting insert prior to sharpening on the JOOLTOOL using the steps below.

MAINTAINING THE CORRECT ANGLE

To maintain the angle of your flat workpieces. Follow these steps.
Example below shows typical molding-bit carbide router bit. Use similar technique for others.

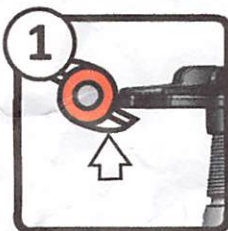

STEP 1:
Lightly make contact with the "back" of the edge to the disc.



STEP 2:
Touch the entire width of the edge flat against the disc. Hold in place.

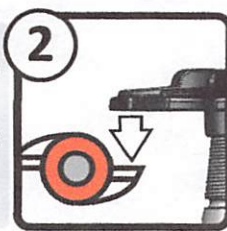

STEP 3:
When desired result is achieved, lower the tool away from the abrasive disc.
DO NOT SLIDE OFF THE DISC! THIS CAN RUIN THE ANGLE OF THE EDGE

SHARPENING STEPS: FROM COARSE TO FINE

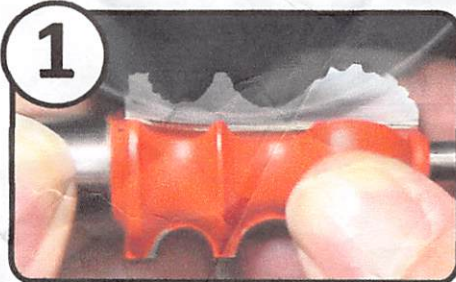

REGRIND ROUGH EDGES OR METAL BLANKS
Use **3M COARSE** Microfinishing Diamond
This step may affect material thickness, depending on duration of grinding.
Speed: High speed (USE DRY, no water needed)
Pressure: Use gentle, constant contact
Motion: Smooth side-to-side or gliding motion



SHARPEN DULL EDGES OR REMOVE NICKS
Use **3M MEDIUM** Microfinishing Diamond
Speed: High speed (USE DRY, no water needed)
Pressure: Use gentle, constant contact
Motion: Smooth side-to-side or gliding motion

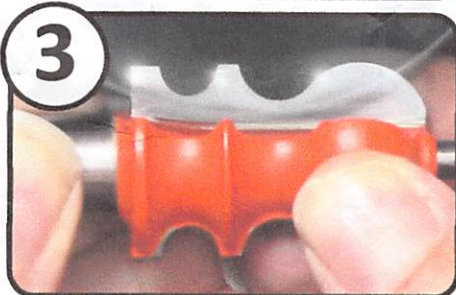

LIGHTLY HONE & MAINTAIN CUTTING EDGES
Use **3M FINE** Microfinishing Diamond
Speed: High speed (USE DRY, no water needed)
Pressure: Use gentle, constant contact
Motion: Smooth side-to-side or gliding motion

FOLLOW FROM TOP TO BOTTOM

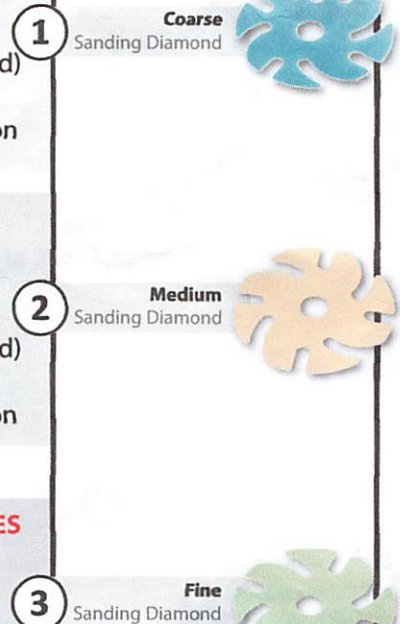

CLEANING: Clean your abrasives regularly with damp cloth for longer life & performance.