

SAPPHIRE WATCH CRYSTAL

SCRATCH REMOVAL & POLISHING STEPS

NOTE: Certain kits may have had **SETUP STEPS A & B** already done for you during packaging.

SETUP



Apply **CUSHIONS** to **BACKPADS**.
FELT DISC does not need a cushion



Apply abrasives onto **BACKPADS**
After **STEP A**.



Use **Water Tray** to apply water to
the workpiece during every step.



SAFETY FIRST!
Always wear eye
and respiratory
protection.

IMPORTANT! Only attempt this on a raised crystal that can physically be touched by the abrasives. If the crystal is inaccessible, it will need to be removed from the case before performing these steps.

ANIE'S TIP: To avoid scratches on finished piece, follow ALL steps THOROUGHLY & inspect your piece after each step.

For Unusual, **VERY DEEP** Scratches: Start at **Step 1a**, then continue down to **FINAL STEP**.

For **DEEP** Scratches: Start at **Step 1c**, then continue down to **FINAL STEP**.

For **LIGHT** scratches: Start at **Step 2a**, then continue down to **FINAL STEP**.

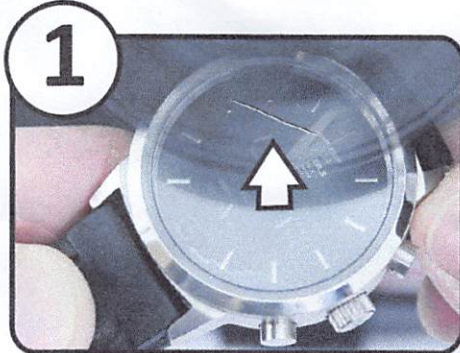

REMOVE VERY DEEP SCRATCHES

Use **3M Microfinishing Diamond** abrasives **SOLELY** to remove very deep scratches or chips from the crystal.

Speed: Medium to High speed with water
Pressure: Use gentle, constant contact
Motion: Smooth orbital motion

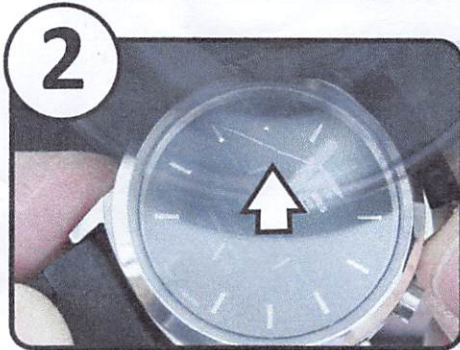

REMOVE LIGHT SCRATCHES AND BRING UP THE POLISH

Progressively remove fine scratches and bring up the polish using **3M Premium Diamond** abrasives, the brown discs.

Speed: Slow Speed (with lots of water)
Pressure: Use gentle, constant contact.
Motion: Smooth orbital motion



FINISH WITH A MIRROR-LIKE POLISH

Use **3M Cerium Oxide** to get a final polish

Speed: Slow (with lots of water)
Pressure: Use gentle, constant contact.
Motion: Smooth orbital motion

FOLLOW FROM TOP TO BOTTOM

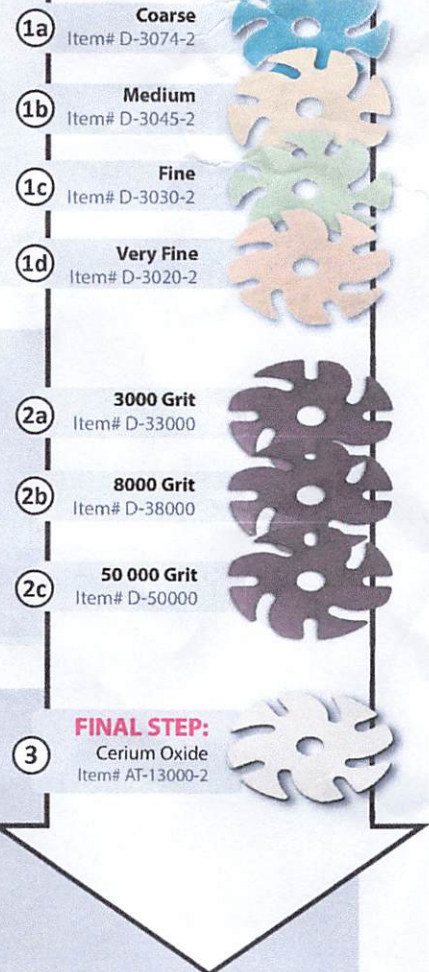

CLEANING: Clean your abrasives regularly with damp cloth for longer life & performance.