

Catalog No. 35-1 ~ 35-2

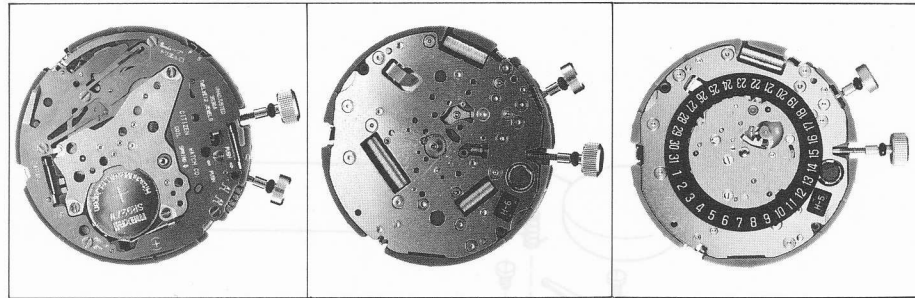

35-1
(Catalog No.)

35-2
(Catalog No.)

35-2
(Catalog No.)

3530A, 3531A

- Analog quartz watch
- Center second hand + register second hand
- Alarm (12H display)
- Timer (Can be set on a 1-minute basis and count up to 49 minutes)
- Chronograph (Can be displayed on a 2/100 sec. basis up to 11 hr. 59 min. 59 sec. 98 in the units of 2/100 sec., second, minute and hour)
- Counter (Counts using base 50 and the timer display)
- Power saving switch
- Power cell life indicator
- Alarm minitor
- 0-second resetting device
- Electromagnetic correction method

Thickness: 3.6mm

3510A

- Analog quartz watch
- Center second hand + register second hand
- Date indication
- Date quick setting device
- Alarm (12H display)
- Timer (Can be set on a 1-minute basis and count up to 49 minutes)
- Chronograph (Can be displayed on a 2/100 sec. basis up to 11 hr. 59 min. 59 sec. 98 in the units of 2/100 sec., second, minute and hour)
- Counter (Counts using base 50 and the timer display)
- Power saving switch
- Power cell life indicator
- Alarm minitor
- 0-second resetting device
- Electromagnetic correction method

Thickness: 4.1mm

Size	30.8mmφ
Oscillation per second	32,768Hz

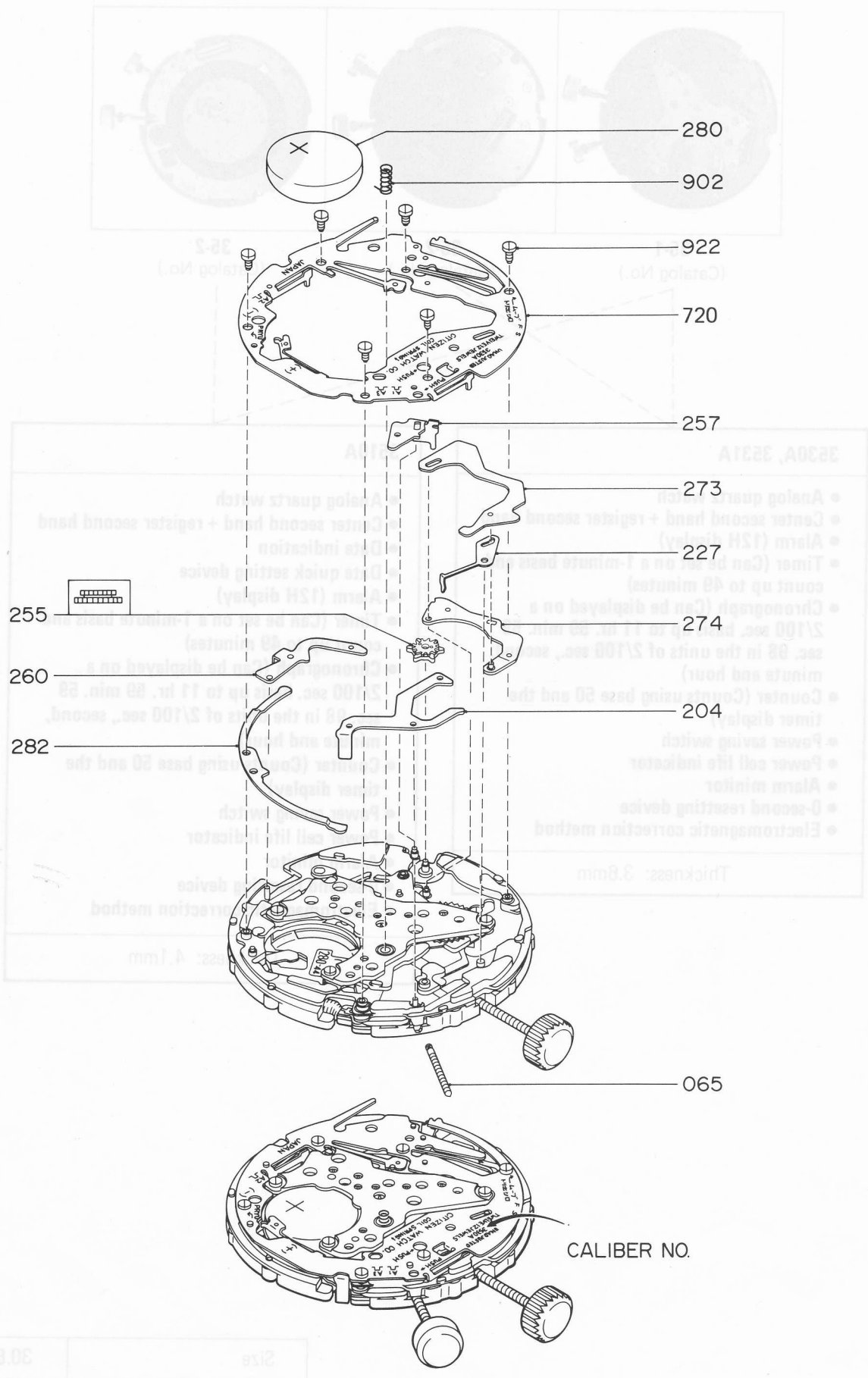

30.8mmφ	Size
32,768Hz	Oscillation per second

Catalog No. 35-1-1

Parts No.	Name of parts	Caliber No.																	
		Nos. of jewels																	
		3510	3530	3531															
		12	12	12															
065	Switching stem	346	—○—	—○—															
204	Stop lever	51	—○—	—○—															
227	Switch spring (IV)	46	—○—	—○—															
255	Pillar wheel	30	—○—	—○—															
257	Operating lever	05	—○—	—○—															
260	Fly-back lever	09	—○—	—○—															
273	Stop connection lever	15	—○—	—○—															
274	Lever for pillar wheel	10	—○—	—○—															
280	Power cell	44	—○—	—○—															
282	Fly-back spring	60	—○—	—○—															
720	Chronograph guard	100		088	121														
902	Buzzer contact spring	199	—○—	—○—															
922	Screw for chronograph guard	128	—○—	—○—															

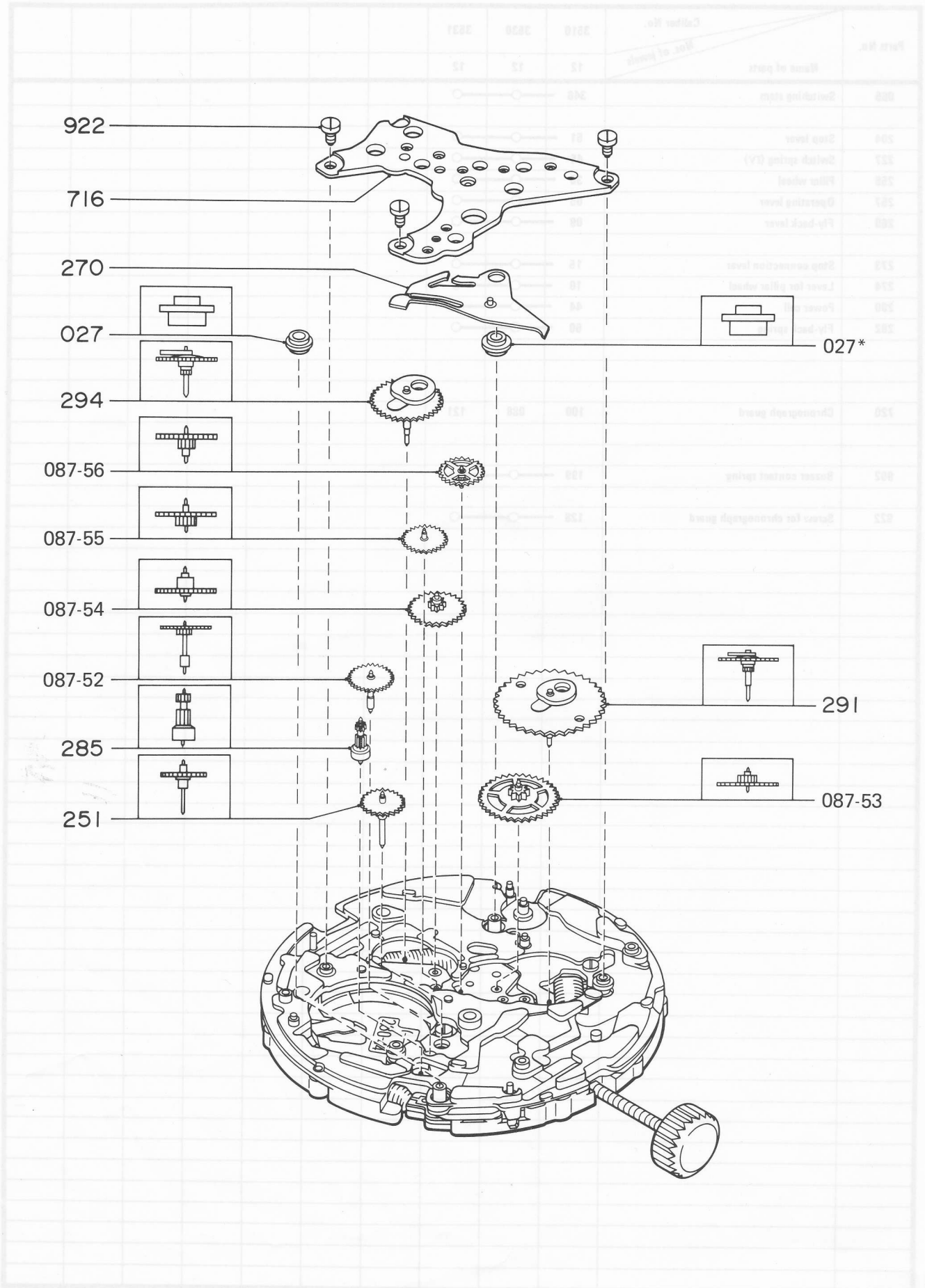

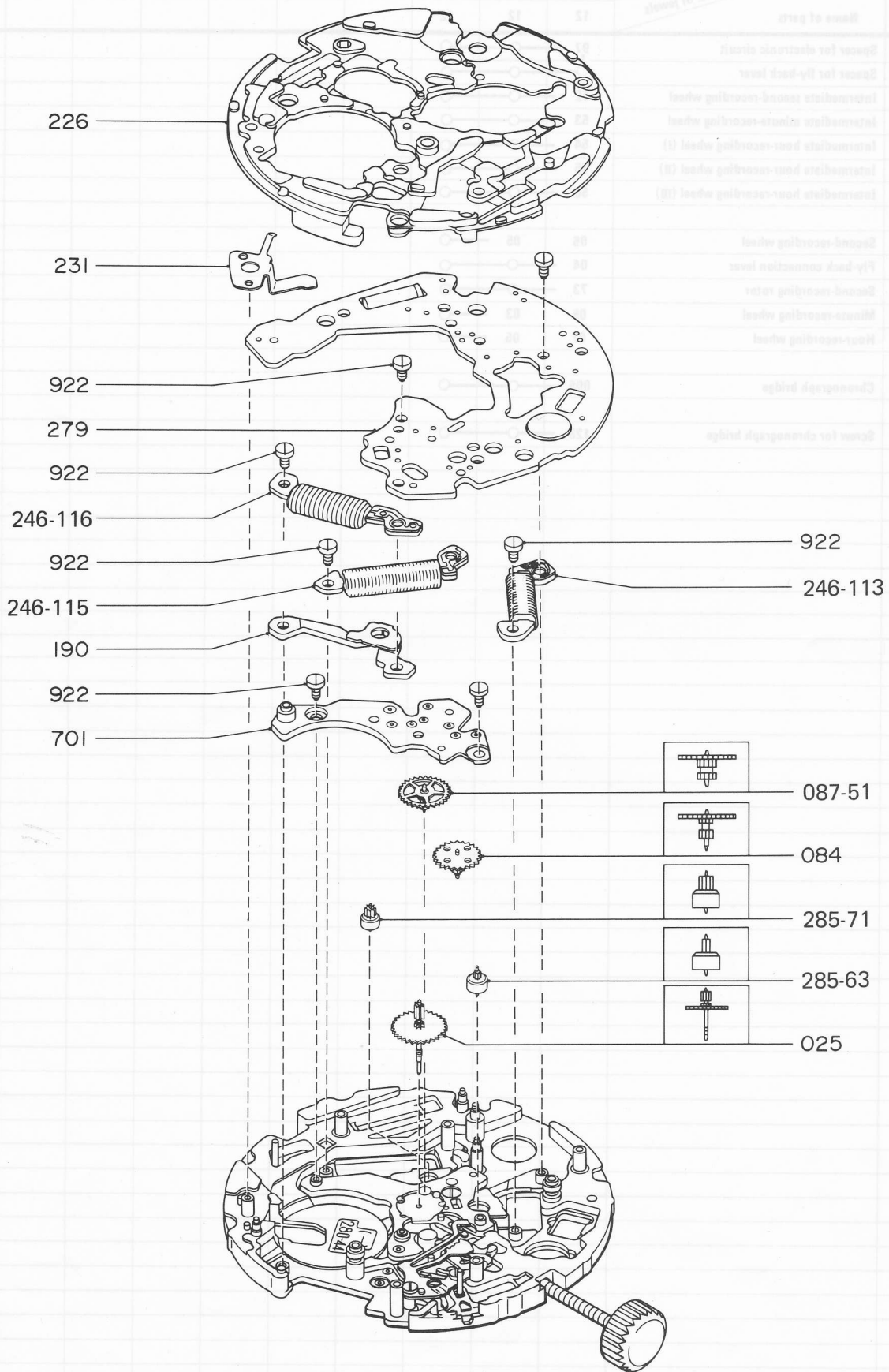

Part No.	Desc of part	Qty	Collor No.
087	Gears for electronic circuit	12	3519
087	Gears for fly-back loop	12	3520
087	Intermediate timing-recording wheel	12	3521
087	Intermediate timing-recording wheel	12	3522
087	Intermediate four-recording wheel (1)	12	3523
087	Intermediate four-recording wheel (2)	12	3524
087	Intermediate four-recording wheel (3)	12	3525
087	Intermediate four-recording wheel (4)	12	3526
087	Intermediate four-recording wheel (5)	12	3527
087	Intermediate four-recording wheel (6)	12	3528
087	Intermediate four-recording wheel (7)	12	3529
087	Intermediate four-recording wheel (8)	12	3530
087	Intermediate four-recording wheel (9)	12	3531
087	Intermediate four-recording wheel (10)	12	3532
087	Intermediate four-recording wheel (11)	12	3533
087	Intermediate four-recording wheel (12)	12	3534
087	Intermediate four-recording wheel (13)	12	3535
087	Intermediate four-recording wheel (14)	12	3536
087	Intermediate four-recording wheel (15)	12	3537
087	Intermediate four-recording wheel (16)	12	3538
087	Intermediate four-recording wheel (17)	12	3539
087	Intermediate four-recording wheel (18)	12	3540
087	Intermediate four-recording wheel (19)	12	3541
087	Intermediate four-recording wheel (20)	12	3542
087	Intermediate four-recording wheel (21)	12	3543
087	Intermediate four-recording wheel (22)	12	3544
087	Intermediate four-recording wheel (23)	12	3545
087	Intermediate four-recording wheel (24)	12	3546
087	Intermediate four-recording wheel (25)	12	3547
087	Intermediate four-recording wheel (26)	12	3548
087	Intermediate four-recording wheel (27)	12	3549
087	Intermediate four-recording wheel (28)	12	3550
087	Intermediate four-recording wheel (29)	12	3551
087	Intermediate four-recording wheel (30)	12	3552
087	Intermediate four-recording wheel (31)	12	3553
087	Intermediate four-recording wheel (32)	12	3554
087	Intermediate four-recording wheel (33)	12	3555
087	Intermediate four-recording wheel (34)	12	3556
087	Intermediate four-recording wheel (35)	12	3557
087	Intermediate four-recording wheel (36)	12	3558
087	Intermediate four-recording wheel (37)	12	3559
087	Intermediate four-recording wheel (38)	12	3560
087	Intermediate four-recording wheel (39)	12	3561
087	Intermediate four-recording wheel (40)	12	3562
087	Intermediate four-recording wheel (41)	12	3563
087	Intermediate four-recording wheel (42)	12	3564
087	Intermediate four-recording wheel (43)	12	3565
087	Intermediate four-recording wheel (44)	12	3566
087	Intermediate four-recording wheel (45)	12	3567
087	Intermediate four-recording wheel (46)	12	3568
087	Intermediate four-recording wheel (47)	12	3569
087	Intermediate four-recording wheel (48)	12	3570
087	Intermediate four-recording wheel (49)	12	3571
087	Intermediate four-recording wheel (50)	12	3572
087	Intermediate four-recording wheel (51)	12	3573
087	Intermediate four-recording wheel (52)	12	3574
087	Intermediate four-recording wheel (53)	12	3575
087	Intermediate four-recording wheel (54)	12	3576
087	Intermediate four-recording wheel (55)	12	3577
087	Intermediate four-recording wheel (56)	12	3578
087	Intermediate four-recording wheel (57)	12	3579
087	Intermediate four-recording wheel (58)	12	3580
087	Intermediate four-recording wheel (59)	12	3581
087	Intermediate four-recording wheel (60)	12	3582
087	Intermediate four-recording wheel (61)	12	3583
087	Intermediate four-recording wheel (62)	12	3584
087	Intermediate four-recording wheel (63)	12	3585
087	Intermediate four-recording wheel (64)	12	3586
087	Intermediate four-recording wheel (65)	12	3587
087	Intermediate four-recording wheel (66)	12	3588
087	Intermediate four-recording wheel (67)	12	3589
087	Intermediate four-recording wheel (68)	12	3590
087	Intermediate four-recording wheel (69)	12	3591
087	Intermediate four-recording wheel (70)	12	3592
087	Intermediate four-recording wheel (71)	12	3593
087	Intermediate four-recording wheel (72)	12	3594
087	Intermediate four-recording wheel (73)	12	3595
087	Intermediate four-recording wheel (74)	12	3596
087	Intermediate four-recording wheel (75)	12	3597
087	Intermediate four-recording wheel (76)	12	3598
087	Intermediate four-recording wheel (77)	12	3599
087	Intermediate four-recording wheel (78)	12	3600
087	Intermediate four-recording wheel (79)	12	3601
087	Intermediate four-recording wheel (80)	12	3602
087	Intermediate four-recording wheel (81)	12	3603
087	Intermediate four-recording wheel (82)	12	3604
087	Intermediate four-recording wheel (83)	12	3605
087	Intermediate four-recording wheel (84)	12	3606
087	Intermediate four-recording wheel (85)	12	3607
087	Intermediate four-recording wheel (86)	12	3608
087	Intermediate four-recording wheel (87)	12	3609
087	Intermediate four-recording wheel (88)	12	3610
087	Intermediate four-recording wheel (89)	12	3611
087	Intermediate four-recording wheel (90)	12	3612
087	Intermediate four-recording wheel (91)	12	3613
087	Intermediate four-recording wheel (92)	12	3614
087	Intermediate four-recording wheel (93)	12	3615
087	Intermediate four-recording wheel (94)	12	3616
087	Intermediate four-recording wheel (95)	12	3617
087	Intermediate four-recording wheel (96)	12	3618
087	Intermediate four-recording wheel (97)	12	3619
087	Intermediate four-recording wheel (98)	12	3620
087	Intermediate four-recording wheel (99)	12	3621
087	Intermediate four-recording wheel (100)	12	3622

Catalog No. 35-1-3

Parts No.	Name of parts	Caliber No.																		
		3510	3530	3531																
		Nos. of jewels																		
		12	12	12																
025	Second wheel	77	73	—○																
084	Fifth wheel and pinion	26	—○	45																
087	Intermediate second wheel	51	—○	—○																
190	Chronograph stator	71	—○	—○																
226	Supporter for electronic circuit	222	—○	—○																
231	Power cell connector spring	153	—○	—○																
246	Coil unit	113	—○	—○																
246	Second coil unit	115	—○	—○																
246	chronograph coil unit	116	—○	—○																
279	Unit of electronic circuit	469	—○	—○																
285	Rotor	63	—○	—○																
285	Second rotor	71	—○	—○																
701	Train wheel bridge	542	—○	—○																
922	Screw for unit of electronic circuit	128	—○	—○																
922	Screw for coil unit	158	—○	—○																
922	Screw for second coil unit	—○	—○	—○																
922	Screw for chronograph coil unit	—○	—○	—○																
922	Screw for train wheel bridge	128	—○	—○																

